



WASHINGTON STATE

Joint Aquatic Resources Permit Application (JARPA) Form^{1,2} [\[help\]](#)

USE BLACK OR BLUE INK TO ENTER ANSWERS IN THE WHITE SPACES BELOW.



US Army Corps
of Engineers®
Seattle District

AGENCY USE ONLY

Date received:

Agency reference #: _____

Tax Parcel #(s): _____

Part 1—Project Identification

1. Project Name (A name for your project that you create. Examples: Smith's Dock or Seabrook Lane Development) [\[help\]](#)

Riverwalk Park Porta-Potty Enclosure

Part 2—Applicant

The person and/or organization responsible for the project. [\[help\]](#)

2a. Name (Last, First, Middle)

2b. Organization (If applicable)

Chelan County PUD

2c. Mailing Address (Street or PO Box)

PO Box 1231

2d. City, State, Zip

Wenatchee, WA 98807

2e. Phone (1)

2f. Phone (2)

2g. Fax

2h. E-mail

¹Additional forms may be required for the following permits:

- If your project may qualify for Department of the Army authorization through a Regional General Permit (RGP), contact the U.S. Army Corps of Engineers for application information (206) 764-3495.
- Not all cities and counties accept the JARPA for their local Shoreline permits. If you need a Shoreline permit, contact the appropriate city or county government to make sure they accept the JARPA.

²To access an online JARPA form with [\[help\]](#) screens, go to <https://www.oria.wa.gov/jarpa-forms>.

For other help, contact the Governor's Office for Regulatory Innovation and Assistance at (800) 917-0043 or help@oria.wa.gov.

Part 3—Authorized Agent or Contact

Person authorized to represent the applicant about the project. (Note: Authorized agent(s) must sign 11b of this application.) [\[help\]](#)

3a. Name (Last, First, Middle)			
Alex White, Environmental Permit Coordinator			
3b. Organization (If applicable)			
Chelan County PUD			
3c. Mailing Address (Street or PO Box)			
PO Box 1231			
3d. City, State, Zip			
Wenatchee, WA 98807			
3e. Phone (1)	3f. Phone (2)	3g. Fax	3h. E-mail
(509) 661-8148			alex.white@chelanpud.org

Part 4—Property Owner(s)

Contact information for people or organizations owning the property(ies) where the project will occur. Consider both **upland and aquatic** ownership because the upland owners may not own the adjacent aquatic land. [\[help\]](#)

- ☒ Same as applicant. (Skip to Part 5.)
- ☐ Repair or maintenance activities on existing rights-of-way or easements. (Skip to Part 5.)
- ☐ There are multiple upland property owners. Complete the section below and fill out [JARPA Attachment A](#) for each additional property owner.
- ☐ Your project is on Department of Natural Resources (DNR)-managed aquatic lands. If you don't know, contact the DNR at (360) 902-1100 to determine aquatic land ownership. If yes, complete [JARPA Attachment E](#) to apply for the Aquatic Use Authorization.

4a. Name (Last, First, Middle)			
4b. Organization (If applicable)			
4c. Mailing Address (Street or PO Box)			
4d. City, State, Zip			
4e. Phone (1)	4f. Phone (2)	4g. Fax	4h. E-mail

Part 5–Project Location(s)

Identifying information about the property or properties where the project will occur. [\[help\]](#)

- ☐ There are multiple project locations (e.g. linear projects). Complete the section below and use [JARPA Attachment B](#) for each additional project location.

5a. Indicate the type of ownership of the property. (Check all that apply.) [help]			
<input type="checkbox"/> Private			
<input type="checkbox"/> Federal			
<input checked="" type="checkbox"/> Publicly owned (state, county, city, special districts like schools, ports, etc.)			
<input type="checkbox"/> Tribal			
<input type="checkbox"/> Department of Natural Resources (DNR) – managed aquatic lands (Complete JARPA Attachment E)			
5b. Street Address (Cannot be a PO Box. If there is no address, provide other location information in 5p.) [help]			
Unassigned (Riverwalk Park)			
5c. City, State, Zip (If the project is not in a city or town, provide the name of the nearest city or town.) [help]			
Chelan, WA 98816			
5d. County [help]			
Chelan			
5e. Provide the section, township, and range for the project location. [help]			
¼ Section	Section	Township	Range
	36	27	22
5f. Provide the latitude and longitude of the project location. [help]			
<ul style="list-style-type: none">Example: 47.03922 N lat. / -122.89142 W long. (Use decimal degrees - NAD 83)			
5g. List the tax parcel number(s) for the project location. [help]			
<ul style="list-style-type: none">The local county assessor's office can provide this information.			
272213650047			
5h. Contact information for all adjoining property owners. (If you need more space, use JARPA Attachment C.) [help]			
Name	Mailing Address	Tax Parcel # (if known)	
Edmunds Property LLC	PO Box 278	272213240200	
	Chelan, WA 98816	272213650015	

5i. List all wetlands on or adjacent to the project location. [help]
None
5j. List all waterbodies (other than wetlands) on or adjacent to the project location. [help]
Chelan River
5k. Is any part of the project area within a 100-year floodplain? [help]
<input type="checkbox"/> Yes <input checked="" type="checkbox"/> No <input type="checkbox"/> Don't know
5l. Briefly describe the vegetation and habitat conditions on the property. [help]
The site is part of Chelan PUD's Riverwalk Park on the south shore of the Chelan River just before the Woodin Ave. bridge. Vegetation on site consists of turf grass and ornamental landscaping. Shoreline habitat conditions are degraded due to the use of the area as a public park.
5m. Describe how the property is currently used. [help]
The property is currently used as a public park (Riverwalk Park). Users of the park visit for swimming, walking, and boating.
5n. Describe how the adjacent properties are currently used. [help]
Adjacent properties are private and currently undeveloped.
5o. Describe the structures (above and below ground) on the property, including their purpose(s) and current condition. [help]
Structures on the southside of Riverview Park include a paved pedestrian trail, boardwalk areas, benches, and a beach / water access area. These are all in fair condition.
5p. Provide driving directions from the closest highway to the project location, and attach a map. [help]
From Wenatchee, travel north on Wenatchee Avenue to US 97A. Stay on US 97A for approximately 40 miles. At the Chelan city limits, US 97A becomes Woodin Ave. Follow Woodin Ave. for approximately two miles and then park just before the Woodin Ave. bridge. The park will be on the right.

Part 6–Project Description

6a. Briefly summarize the overall project. You can provide more detail in 6b. [help]
The proposed project would involve the construction of a porta-potty enclosure approximately 125 feet away from the OHW of the Chelan River.
6b. Describe the purpose of the project and why you want or need to perform it. [help]
The purpose of the project is to enhance public recreation opportunities and increase site sanitation. Currently there are no public restrooms available on the south shore riverwalk.

6c. Indicate the project category. (Check all that apply) [help]				
<input type="checkbox"/> Commercial	<input type="checkbox"/> Residential	<input type="checkbox"/> Institutional	<input type="checkbox"/> Transportation	<input checked="" type="checkbox"/> Recreational
<input type="checkbox"/> Maintenance	<input type="checkbox"/> Environmental Enhancement			
6d. Indicate the major elements of your project. (Check all that apply) [help]				
<input type="checkbox"/> Aquaculture <input type="checkbox"/> Bank Stabilization <input type="checkbox"/> Boat House <input type="checkbox"/> Boat Launch <input type="checkbox"/> Boat Lift <input type="checkbox"/> Bridge <input type="checkbox"/> Bulkhead <input type="checkbox"/> Buoy <input type="checkbox"/> Channel Modification	<input type="checkbox"/> Culvert <input type="checkbox"/> Dam / Weir <input type="checkbox"/> Dike / Levee / Jetty <input type="checkbox"/> Ditch <input type="checkbox"/> Dock / Pier <input type="checkbox"/> Dredging <input type="checkbox"/> Fence <input type="checkbox"/> Ferry Terminal <input type="checkbox"/> Fishway	<input type="checkbox"/> Float <input type="checkbox"/> Floating Home <input type="checkbox"/> Geotechnical Survey <input type="checkbox"/> Land Clearing <input type="checkbox"/> Marina / Moorage <input type="checkbox"/> Mining <input type="checkbox"/> Outfall Structure <input type="checkbox"/> Piling/Dolphin <input type="checkbox"/> Raft	<input type="checkbox"/> Retaining Wall (upland) <input type="checkbox"/> Road <input type="checkbox"/> Scientific Measurement Device <input type="checkbox"/> Stairs <input type="checkbox"/> Stormwater facility <input type="checkbox"/> Swimming Pool <input type="checkbox"/> Utility Line	
<input checked="" type="checkbox"/> Other: Structure within the 200-ft. shoreline jurisdiction.				
6e. Describe how you plan to construct each project element checked in 6d. Include specific construction methods and equipment to be used. [help]				
<ul style="list-style-type: none"> Identify where each element will occur in relation to the nearest waterbody. Indicate which activities are within the 100-year floodplain. 				
<p>Construction Sequencing:</p> <ul style="list-style-type: none"> Mobilize project equipment and materials to the site; Install temporary Best Management Practices (BMPs) including silt fence and stabilized construction ingress/egress; Grade and prepare the area of the park where concrete pad will be installed; Build forms for the concrete pad and pour cement; After cement cures, then construct porta-potty enclosure; Remove temporary BMPs, demobilize project equipment and materials from site, and restore site to preconstruction/designed conditions; Re-seed disturbed areas with grass seed; Install porta-potty. 				
6f. What are the anticipated start and end dates for project construction? (Month/Year) [help]				
<ul style="list-style-type: none"> If the project will be constructed in phases or stages, use JARPA Attachment D to list the start and end dates of each phase or stage. 				
Start Date: <u>August 2025</u>		End Date: <u>September 2025</u>		<input type="checkbox"/> See JARPA Attachment D
6g. Fair market value of the project, including materials, labor, machine rentals, etc. [help]				
\$32,000				
6h. Will any portion of the project receive federal funding? [help]				
<ul style="list-style-type: none"> If yes, list each agency providing funds. 				
<input type="checkbox"/> Yes <input checked="" type="checkbox"/> No <input type="checkbox"/> Don't know				

Part 7–Wetlands: Impacts and Mitigation

- ☐ Check here if there are wetlands or wetland buffers on or adjacent to the project area.
(If there are none, skip to Part 8.) [\[help\]](#)

7a. Describe how the project has been designed to avoid and minimize adverse impacts to wetlands. [help]						
<input checked="" type="checkbox"/> Not applicable						
7b. Will the project impact wetlands? [help]						
<input type="checkbox"/> Yes <input checked="" type="checkbox"/> No <input type="checkbox"/> Don't know						
7c. Will the project impact wetland buffers? [help]						
<input type="checkbox"/> Yes <input checked="" type="checkbox"/> No <input type="checkbox"/> Don't know						
7d. Has a wetland delineation report been prepared? [help]						
<ul style="list-style-type: none"> If Yes, submit the report, including data sheets, with the JARPA package. 						
<input type="checkbox"/> Yes <input checked="" type="checkbox"/> No						
7e. Have the wetlands been rated using the Western Washington or Eastern Washington Wetland Rating System? [help]						
<ul style="list-style-type: none"> If Yes, submit the wetland rating forms and figures with the JARPA package. 						
<input type="checkbox"/> Yes <input type="checkbox"/> No <input type="checkbox"/> Don't know						
7f. Have you prepared a mitigation plan to compensate for any adverse impacts to wetlands? [help]						
<ul style="list-style-type: none"> If Yes, submit the plan with the JARPA package and answer 7g. If No, or Not applicable, explain below why a mitigation plan should not be required. 						
<input type="checkbox"/> Yes <input checked="" type="checkbox"/> No <input type="checkbox"/> Don't know						
7g. Summarize what the mitigation plan is meant to accomplish, and describe how a watershed approach was used to design the plan. [help]						
7h. Use the table below to list the type and rating of each wetland impacted, the extent and duration of the impact, and the type and amount of mitigation proposed. Or if you are submitting a mitigation plan with a similar table, you can state (below) where we can find this information in the plan. [help]						
Activity (fill, drain, excavate, flood, etc.)	Wetland Name ¹	Wetland type and rating category ²	Impact area (sq. ft. or Acres)	Duration of impact ³	Proposed mitigation type ⁴	Wetland mitigation area (sq. ft. or acres)

¹ If no official name for the wetland exists, create a unique name (such as "Wetland 1"). The name should be consistent with other project documents, such as a wetland delineation report.

² Ecology wetland category based on current Western Washington or Eastern Washington Wetland Rating System. Provide the wetland rating forms with the JARPA package.

³ Indicate the days, months or years the wetland will be measurably impacted by the activity. Enter "permanent" if applicable.

⁴ Creation (C), Re-establishment/Rehabilitation (R), Enhancement (E), Preservation (P), Mitigation Bank/In-lieu fee (B)

Page number(s) for similar information in the mitigation plan, if available: _____

7i. For all filling activities identified in 7h, describe the source and nature of the fill material, the amount in cubic yards that will be used, and how and where it will be placed into the wetland. [\[help\]](#)

7j. For all excavating activities identified in 7h, describe the excavation method, type and amount of material in cubic yards you will remove, and where the material will be disposed. [\[help\]](#)

Part 8—Waterbodies (other than wetlands): Impacts and Mitigation

In Part 8, "waterbodies" refers to non-wetland waterbodies. (See Part 7 for information related to wetlands.) [\[help\]](#)

☐ Check here if there are waterbodies on or adjacent to the project area. (If there are none, skip to Part 9.)

8a. Describe how the project is designed to avoid and minimize adverse impacts to the aquatic environment. [\[help\]](#)

☐ Not applicable

The entire project would take place approximately 125 ft. from the OHW of the Chelan River. Temporary BMPs that would be installed prior to construction to ensure that the project would avoid adverse impacts to the aquatic environment.

8b. Will your project impact a waterbody or the area around a waterbody? [\[help\]](#)

☒ Yes ☐ No

8c. Have you prepared a mitigation plan to compensate for the project's adverse impacts to non-wetland waterbodies? [\[help\]](#)

- **If Yes**, submit the plan with the JARPA package and answer 8d.
- **If No, or Not applicable**, explain below why a mitigation plan should not be required.

☐ Yes ☒ No ☐ Don't know

No native habitat would be disturbed from project construction, only existing ornamental lawn grass. Once the project has been built, disturbed areas would be reseeded with lawn grass seed.

8d. Summarize what the mitigation plan is meant to accomplish. Describe how a watershed approach was used to design the plan.

- If you already completed 7g you do not need to restate your answer here. [\[help\]](#)

By reseeding disturbed areas, the proposed project would result in no net loss of shoreline habitat.

8e. Summarize impact(s) to each waterbody in the table below. [\[help\]](#)

Activity (clear, dredge, fill, pile drive, etc.)	Waterbody name ¹	Impact location ²	Duration of impact ³	Amount of material (cubic yards) to be placed in or removed from waterbody	Area (sq. ft. or linear ft.) of waterbody directly affected
Prepare site by clearing and grading.	Chelan River	Approximately 125 ft. away from the OHW of the Chelan River.	1 week	N/A	N/A
Construction of enclosure	Chelan River	Approximately 125 ft. away from the OHW of the Chelan River.	1 week	N/A	N/A

¹ If no official name for the waterbody exists, create a unique name (such as "Stream 1") The name should be consistent with other documents provided.

² Indicate whether the impact will occur in or adjacent to the waterbody. If adjacent, provide the distance between the impact and the waterbody and indicate whether the impact will occur within the 100-year flood plain.

³ Indicate the days, months or years the waterbody will be measurably impacted by the work. Enter "permanent" if applicable.

8f. For all activities identified in 8e, describe the source and nature of the fill material, amount (in cubic yards) you will use, and how and where it will be placed into the waterbody. [\[help\]](#)

No fill would be placed into the Chelan River or any other waterbody.

8g. For all excavating or dredging activities identified in 8e, describe the method for excavating or dredging, type and amount of material you will remove, and where the material will be disposed. [\[help\]](#)

No excavation or dredging activities would take place below the OHW of the Chelan River.

8h. Have you prepared a Water Quality Monitoring Plan (WQMP) for all in-water work (below ordinary high water), over water work or discharges to waters of the state?

☐ Yes ☒ No

If NO describe the monitoring that you will be conducting including parameters, equipment and locations, or explain why monitoring will not be necessary. [\[help\]](#)

No in-water work would occur and no discharges to waters of the state would occur due to the BMPs installed prior to construction commencing.

Part 9—Additional Information

Any additional information you can provide helps the reviewer(s) understand your project. Complete as much of this section as you can. It is ok if you cannot answer a question.

9a. If you have already worked with any government agencies on this project, list them below. [help]			
Agency Name	Contact Name	Phone	Most Recent Date of Contact
City of Chelan	Monica Libby	(509) 682-8037	June 16, 2025
9b. Are any of the wetlands or waterbodies identified in Part 7 or Part 8 of this JARPA on the Washington Department of Ecology's 303(d) List? [help] <ul style="list-style-type: none">• If Yes, list the parameter(s) below.• If you don't know, use Washington Department of Ecology's Water Quality Assessment tools at: https://ecology.wa.gov/Water-Shorelines/Water-quality/Water-improvement/Assessment-of-state-waters-303d.			
<input type="checkbox"/> Yes <input checked="" type="checkbox"/> No			
9c. What U.S. Geological Survey Hydrological Unit Code (HUC) is the project in? [help] <ul style="list-style-type: none">• Go to http://cfpub.epa.gov/surf/locate/index.cfm to help identify the HUC.			
170200090305			
9d. What Water Resource Inventory Area Number (WRIA #) is the project in? [help] <ul style="list-style-type: none">• Go to https://ecology.wa.gov/Water-Shorelines/Water-supply/Water-availability/Watershed-look-up to find the WRIA #.			
47 - Chelan			
9e. Will the in-water construction work comply with the State of Washington water quality standards for turbidity? [help] <ul style="list-style-type: none">• Go to https://ecology.wa.gov/Water-Shorelines/Water-quality/Freshwater/Surface-water-quality-standards/Criteria for the standards.			
<input type="checkbox"/> Yes <input type="checkbox"/> No <input checked="" type="checkbox"/> Not applicable			
9f. If the project is within the jurisdiction of the Shoreline Management Act, what is the local shoreline environment designation? [help] <ul style="list-style-type: none">• If you don't know, contact the local planning department.• For more information, go to: https://ecology.wa.gov/Water-Shorelines/Shoreline-coastal-management/Shoreline-coastal-planning/Shoreline-laws-rules-and-cases.			
<input type="checkbox"/> Urban <input type="checkbox"/> Natural <input type="checkbox"/> Aquatic <input type="checkbox"/> Conservancy <input checked="" type="checkbox"/> Other: <u>Shoreline Park / Public</u>			
9g. What is the Washington Department of Natural Resources Water Type? [help] <ul style="list-style-type: none">• Go to http://www.dnr.wa.gov/forest-practices-water-typing for the Forest Practices Water Typing System.			
<input type="checkbox"/> Shoreline <input checked="" type="checkbox"/> Fish <input type="checkbox"/> Non-Fish Perennial <input type="checkbox"/> Non-Fish Seasonal			
9h. Will this project be designed to meet the Washington Department of Ecology's most current stormwater manual? [help] <ul style="list-style-type: none">• If No, provide the name of the manual your project is designed to meet.			
<input checked="" type="checkbox"/> Yes <input type="checkbox"/> No			

Name of manual: _____
9i. Does the project site have known contaminated sediment? [help] <ul style="list-style-type: none"> If Yes, please describe below.
<input type="checkbox"/> Yes <input checked="" type="checkbox"/> No
9j. If you know what the property was used for in the past, describe below. [help]
9k. Is the project located in or adjacent to a designated state or federal contaminated site or clean-up site. (e.g. MTCA or CERCLA)? <ul style="list-style-type: none"> If Yes, provide any additional details below.
<input type="checkbox"/> Yes <input checked="" type="checkbox"/> No
9l. Has a cultural resource (archaeological) survey been performed on the project area? [help] <ul style="list-style-type: none"> If Yes, attach it to your JARPA package.
<input checked="" type="checkbox"/> Yes <input type="checkbox"/> No
9m. Name each species listed under the federal Endangered Species Act that occurs in the vicinity of the project area or might be affected by the proposed work. [help]
No species listed under the Federal Endangered Species Act are present in the project area.
9n. Name each species or habitat on the Washington Department of Fish and Wildlife's Priority Habitats and Species List that might be affected by the proposed work. [help]
WDFW's Priority Habitats and Species maps did not list any species or habitats in the project area.

Part 10–SEPA Compliance and Permits

Use the resources and checklist below to identify the permits you are applying for.

- Online Project Questionnaire at <http://apps.oria.wa.gov/opas/>.
- Governor's Office for Regulatory Innovation and Assistance at (800) 917-0043 or help@oria.wa.gov.
- For a list of addresses to send your JARPA to, click on [agency addresses for completed JARPA](#).

10a. Compliance with the State Environmental Policy Act (SEPA). (Check all that apply.) [help] <ul style="list-style-type: none"> For more information about SEPA, go to https://ecology.wa.gov/regulations-permits/SEPA-environmental-review.
<input type="checkbox"/> A copy of the SEPA determination or letter of exemption is included with this application.
<input type="checkbox"/> A SEPA determination is pending with _____ (lead agency). The expected decision date is _____.
<input type="checkbox"/> I am applying for a Fish Habitat Enhancement Exemption. (Check the box below in 10b.) [help]

- ☒ This project is exempt (choose type of exemption below).
- ☐ Categorical Exemption. Under what section of the SEPA administrative code (WAC) is it exempt?
WAC 197-11-800(1)
- ☐ Other: _____
- ☐ SEPA is pre-empted by federal law.

10b. Indicate the permits you are applying for. (Check all that apply.) [\[help\]](#)

LOCAL GOVERNMENT

Local Government Shoreline permits:

- ☒ Substantial Development ☐ Conditional Use ☐ Variance
- ☐ Shoreline Exemption Type (explain): _____

Other City/County permits:

- ☐ Floodplain Development Permit ☐ Critical Areas Ordinance

STATE GOVERNMENT

Washington Department of Fish and Wildlife:

- ☐ Hydraulic Project Approval (HPA) ☐ Fish Habitat Enhancement Exemption – [Attach Exemption Form](#)

Washington Department of Natural Resources:

- ☐ Aquatic Use Authorization
- Complete [JARPA Attachment E](#) and submit a check for \$25 payable to the Washington Department of Natural Resources.
Do not send cash.

Washington Department of Ecology:

- ☐ Section 401 Water Quality Certification
- ☐ Authorization to impact waters of the state, including wetlands (Check this box if the proposed impacts are to waters not subject to the federal Clean Water Act)

FEDERAL AND TRIBAL GOVERNMENT

United States Department of the Army (U.S. Army Corps of Engineers):

- ☐ Section 404 (discharges into waters of the U.S.) ☐ Section 10 (work in navigable waters)

United States Coast Guard:

For projects or bridges over waters of the United States, contact the U.S. Coast Guard at:

- ☐ Bridge Permit: D13-SMB-D13-BRIDGES@uscg.mil
- ☐ Private Aids to Navigation (or other non-bridge permits): D13-SMB-D13-PATON@uscg.mil

United States Environmental Protection Agency:

- ☐ Section 401 Water Quality Certification (discharges into waters of the U.S.) on tribal lands where tribes do not have treatment as a state (TAS)

Tribal Permits: (Check with the tribe to see if there are other tribal permits, e.g., Tribal Environmental Protection Act, Shoreline Permits, Hydraulic Project Permits, or other in addition to CWA Section 401 WQC)

- ☐ Section 401 Water Quality Certification (discharges into waters of the U.S.) where the tribe has treatment as a state (TAS).

Part 11—Authorizing Signatures

Signatures are required before submitting the JARPA package. The JARPA package includes the JARPA form, project plans, photos, etc. [\[help\]](#)

11a. Applicant Signature (required) [\[help\]](#)

I certify that to the best of my knowledge and belief, the information provided in this application is true, complete, and accurate. I also certify that I have the authority to carry out the proposed activities, and I agree to start work only after I have received all necessary permits.

I hereby authorize the agent named in Part 3 of this application to act on my behalf in matters related to this application. AW (initial)

By initialing here, I state that I have the authority to grant access to the property. I also give my consent to the permitting agencies entering the property where the project is located to inspect the project site or any work related to the project. AW (initial)

Alex White Alex White 6/27/25
Applicant Printed Name Applicant Signature Date

11b. Authorized Agent Signature [\[help\]](#)

I certify that to the best of my knowledge and belief, the information provided in this application is true, complete, and accurate. I also certify that I have the authority to carry out the proposed activities and I agree to start work only after all necessary permits have been issued.

Alex White Alex White 6/27/25
Authorized Agent Printed Name Authorized Agent Signature Date

11c. Property Owner Signature (if not applicant) [\[help\]](#)

Not required if project is on existing rights-of-way or easements (provide copy of easement with JARPA).

I consent to the permitting agencies entering the property where the project is located to inspect the project site or any work. These inspections shall occur at reasonable times and, if practical, with prior notice to the landowner.

Property Owner Printed Name Property Owner Signature Date

18 U.S.C §1001 provides that: Whoever, in any manner within the jurisdiction of any department or agency of the United States knowingly falsifies, conceals, or covers up by any trick, scheme, or device a material fact or makes any false, fictitious, or fraudulent statements or representations or makes or uses any false writing or document knowing same to contain any false, fictitious, or fraudulent statement or entry, shall be fined not more than \$10,000 or imprisoned not more than 5 years or both.

If you require this document in another format, contact the Governor's Office for Regulatory Innovation and Assistance (ORIA) at (800) 917-0043. People with hearing loss can call 711 for Washington Relay Service. People with a speech disability can call (877) 833-6341. ORIA publication number: ORIA-16-011 rev. 09/2018



**Porta Potty Enclosure -
Approx**



PLEASE
PICK UP
AFTER
YOUR PET



A photograph of a stone retaining wall in a park-like setting. The wall is constructed from large, grey, rectangular stone blocks. A horizontal blue line is drawn across the middle of the wall, with the text "OHWM 1098'" in blue, bold, sans-serif font centered on it. The wall is flanked by large, irregularly shaped rocks. In the background, there is a black metal bench, a wooden fence, and several trees with green foliage. The foreground is a light-colored, sandy or gravelly surface.

OHWM 1098'

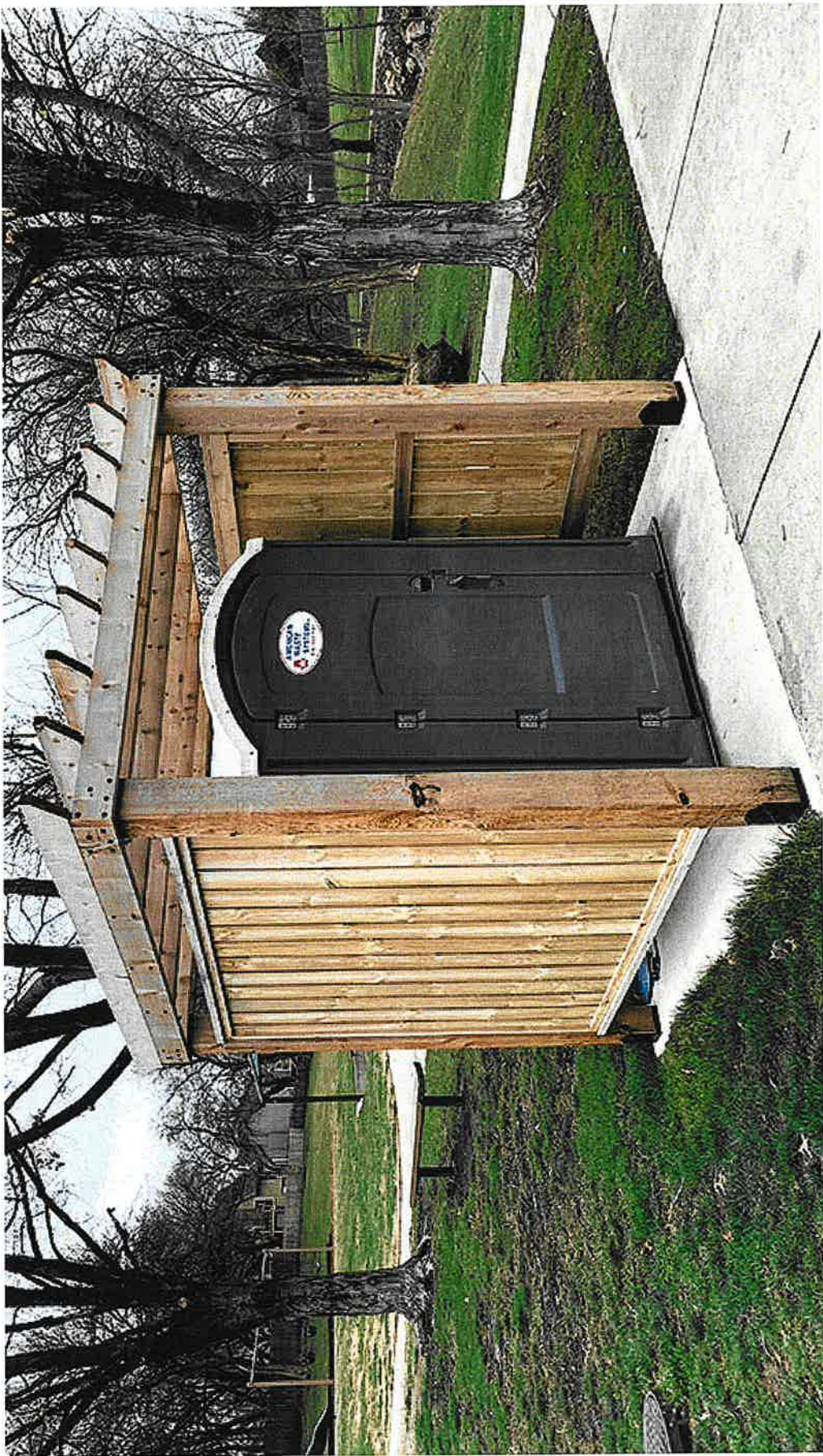

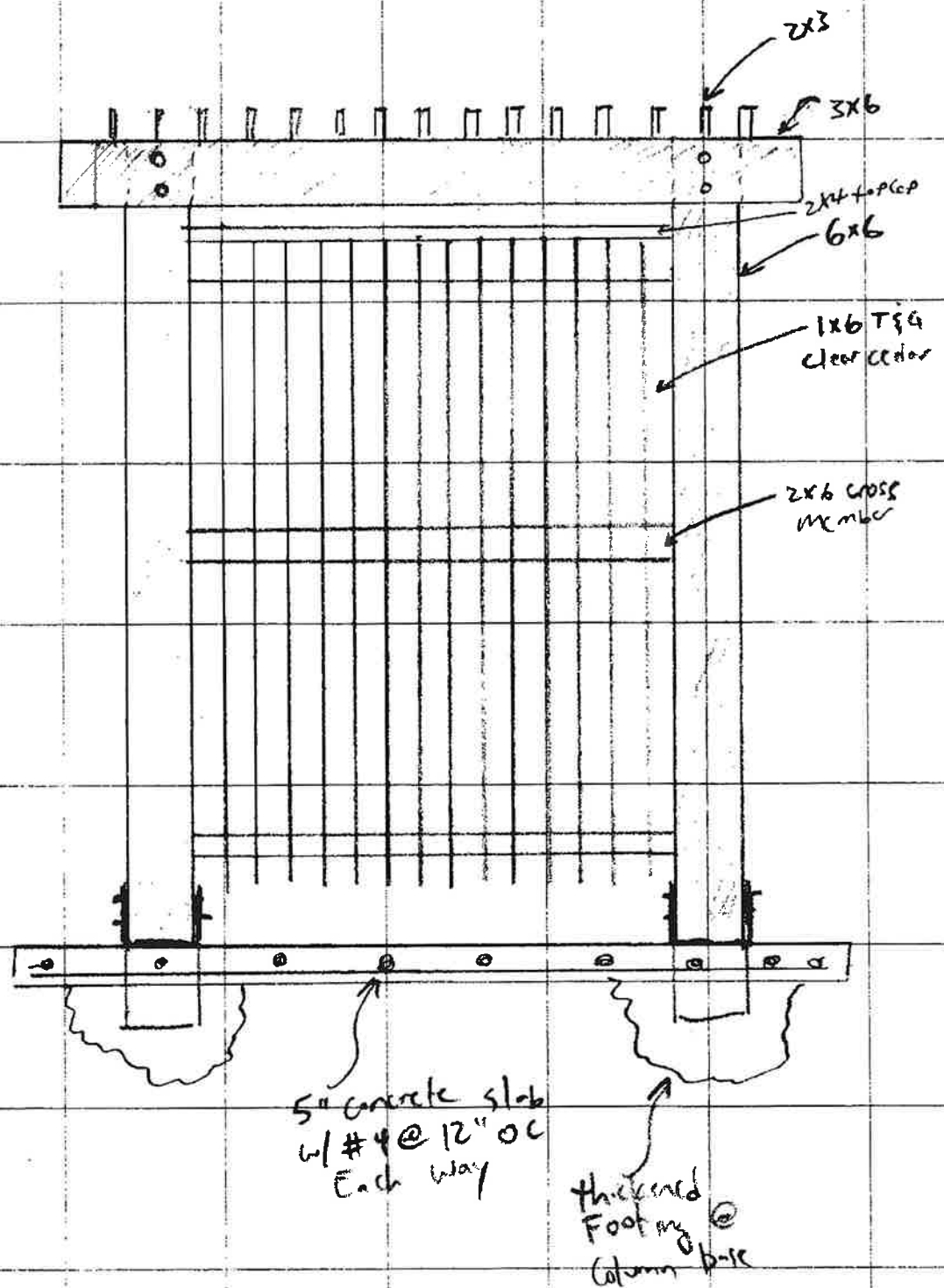

Wooden AVE ADA Porta Potty Enclosure

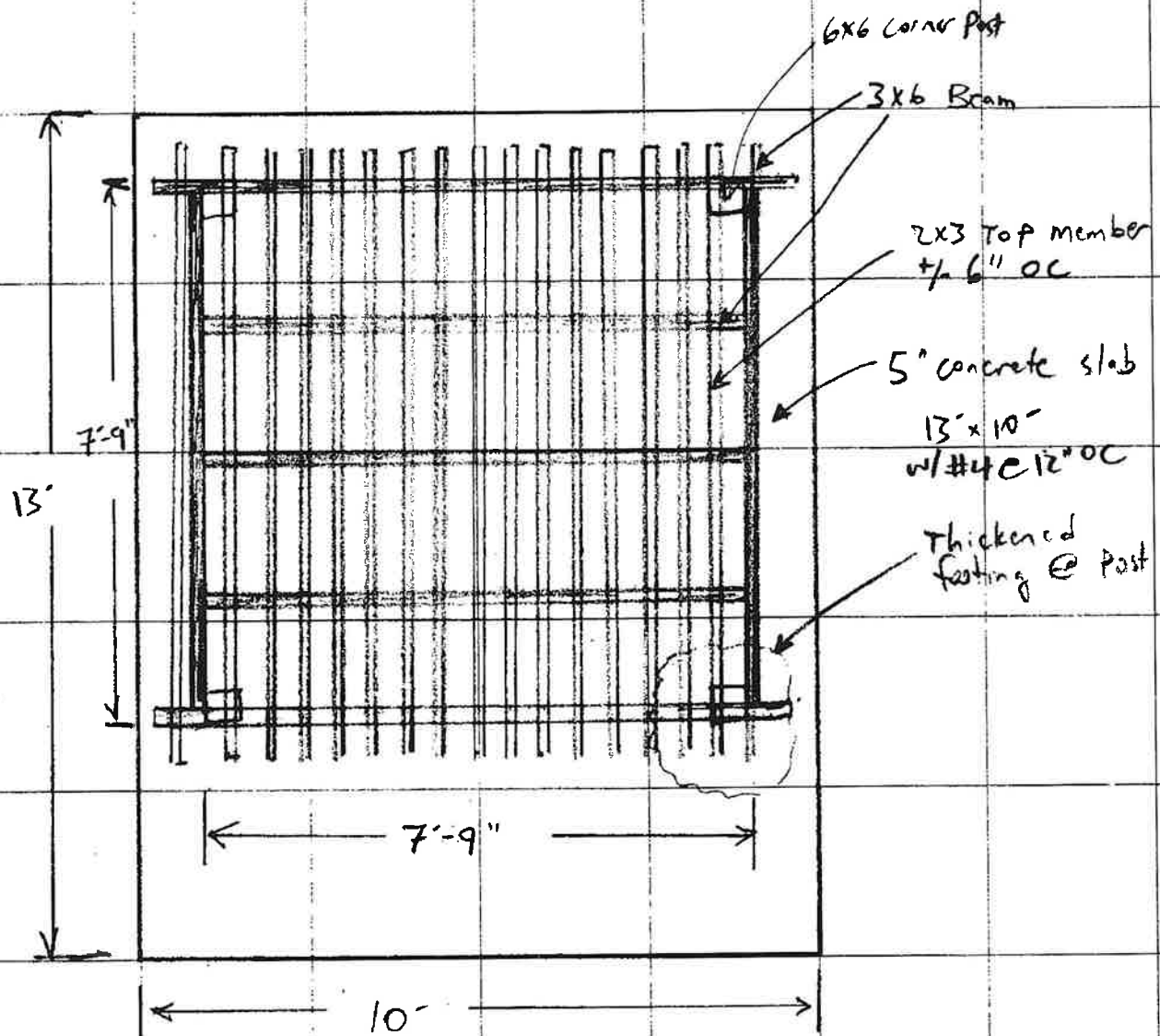

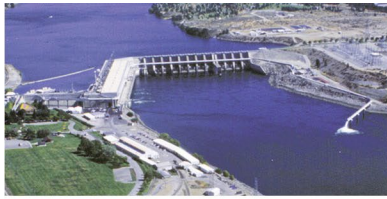

PUBLIC UTILITY DISTRICT NO. 1 of CHELAN COUNTY

P.O. Box 1231, Wenatchee, WA 98807-1231 • 203 Olds Station Rd., Wenatchee, WA 98801

(509) 663-8121 • Toll free 1-888-663-8121 • www.chelanpud.org

City of Chelan SMP Compliance Memo:

June 27, 2025

Monica Libbey, Senior Planner
City of Chelan

Mrs. Libbey,

Chelan County PUD (CCPUD) is proposing to construct a porta-potty enclosure within Riverview Park (proposed project) as shown in Exhibit A. This enclosure would be placed on a cement pad that is approximately 13' x 10' (130 sq.ft.) in size that would be located approximately 125 ft. away from the Ordinary High Water (OHW) of the Chelan River (Exhibit B).

CCPUD's request for a Shoreline Substantial Development Permit meets the following criteria outlined in the City of Chelan Shoreline Master Program (CSMP):

Chapter 3 – Shoreline Jurisdiction and Environment Designations

CSMP Section 3.2.1. - According to City of Chelan shoreline maps, the subject property, which consists of the southeastern portion of Riverwalk Park, is owned by CCPUD, and is within the Shoreline Park / Public environment.

A.1 - Purpose

- a. The proposed project is compatible with the designated use of the 200-ft. shoreline buffer as a "Nonwater-Oriented Recreational Use" pursuant to Table 3-1 in the CSMP.
- b. The construction of the proposed project would ensure that appropriate development and subsequent management of the existing Riverwalk Park is occurring. This public restroom would be available to users of Riverwalk Park and would help prevent any unsanitary conditions that may result if the project was not built.

A.2 – Designation Criteria

- a. The proposed project is being developed in accordance with the CSMP by accommodating public access and recreational development that is compatible while maintaining the existing ecological functions of the area.
- b. The proposed project is suitable for water-related/enjoyment uses.
- c. The proposed project is not within designated open space or floodplains.
- d. No net loss of shoreline habitat function is expected to occur due to the construction of the proposed project since only existing non-native manicured grass is being removed.

A.3 – Management Policies

- a. No net loss of shoreline habitat function is expected to occur due to the construction of the proposed project since only existing non-native manicured grass is being removed.

- b. The proposed project would be located upland of the existing paved trail. It would not impede any future water-orientated uses.
- c. The proposed project is compatible with the purpose and the setting of the existing Riverwalk Park.
- d. Temporary BMPs would be installed prior to construction of the proposed project. Upon project completion, all disturbed areas would be re-seeded and therefore result in no net loss of shoreline ecological functions.

CSMP Section 3.2.2 – The use matrix Table 3.1 and development standards provide clear administration of the CSMP

- A – The proposed project is an allowed use in the Shoreline Park / Public environment through the approval of a shoreline development permit and a subsequent building permit.
- B – Riverwalk Park is already established; therefore, the proposed project can move forward as an accessory use.
- C – The proposed project is an allowed use by the underlining zoning designation.
- D – The proposed project is classified as a “Nonwater-Oriented Recreational Use”; therefore, only a shoreline development permit is necessary (not a shoreline conditional use permit).
- E – The proposed project does not meet any of the exemption criteria; therefore, a shoreline development permit is necessary.
- F – See E above.
- G – Not Applicable.
- H – The proposed project would comply with the designated shoreline development standards.
- I – The proposed project would comply with the designated shoreline setback.
- J – The CSMP shoreline development standards are the prevailing regulation for the proposed project.
- K – Not Applicable.
- L – The proposed project is not eligible for a shoreline exemption.

Chapter 4 – General Regulations

CSMP Section 4.2.2 – The provisions of this Section and the Critical Areas Regulations in Appendix B shall apply to any use or development within the 200-ft. shoreline jurisdiction.

- B – Mitigation sequencing – After the 2nd step of mitigation sequencing, which minimizes impacts of the proposed project by locating it beyond the 100 ft. buffer setback within a section of non-native manicured grass, all impacts have been mitigated for. The proposed project would not result in the loss of any shoreline habitat function since only non-natural vegetation is being removed.

CSMP Section 4.3.2 – The proposed project meets the City Shoreline Public Access Plan and does not impede the public from utilizing Riverwalk Park to access the Chelan River.

CSMP Section 4.4.2

- A – The proposed project was sited so that no significant trees or native vegetation would be removed during construction activities.
- B – There would be no impact to the existing primary use of the subject property from the construction of the proposed project.
- C – There would be no adverse impact to the existing vegetation within Riverwalk Park from construction of the proposed project since any ground disturbance would only involve the removal of existing lawn outside of the shoreline setback of 100 ft. as described in CSMP Section 4.4.2.C.2.a.

D – No mitigation would be required for the construction of the proposed project because there would be no native shoreline habitat being removed during project construction. All disturbed areas would be revegetated with a lawn grass seed mix.

E – No trees would be removed for the construction of the proposed project.

F – Not Applicable.

G – Not Applicable.

H – The required clearing and grading for the proposed project would be the minimum necessary and would be in conformance with the provisions of Section 4.2 and Appendix B of the CSMP.

I – Not Applicable.

J – Not Applicable.

CSMP Section 4.4.3

A – For the proposed project, CCPUD is not requesting a reduced setback as the project would be approximately 125 ft. away from the OHW of the Chelan River, which exceeds the minimum setback listed in Table 4.4-1.

B – Not Applicable

C – Not Applicable

D – Not Applicable

E – Not Applicable

F – Not Applicable

G – Not Applicable

Chapter 5 – Shoreline Modifications and Uses

CSMP Section 5.13.2

A – The proposed project is related to the enjoyment and use of the water and shorelines of the state.

B – The proposed project is designed, located, and operated consistent with the purpose and intensity of the Shoreline Park/Public environment designation.

C – The proposed project is located outside of the 100 ft. shoreline setback.

D – Not Applicable

E – Not Applicable

F – The purpose of the project is to develop a structure that would house a porta-potty and would screen it from neighboring properties as well as other users of the park.

G – Not Applicable

H – The proposed project would result in no net loss of shoreline ecological function since no native vegetation is being removed.

I – Not Applicable

J – Not Applicable

Chapter 7 – Shoreline Permits, Procedures and Administration

CSMP Section 7.5.2

A – By being approved by Ecology, the CSMP demonstrates that its policies and procedures are consistent with RCW 90.58, which establishes a cooperative program between local governments and the state.

B – WAC 173-27 is the governance used by local governments to establish a program for the administration and enforcement of the permit system for shoreline management. The City of Chelan has complied with this requirement by adopting a SMP and receiving approval by Ecology.

C – The purpose of this SMP Compliance Memo is to demonstrate the proposed project's compliance with the CSMP and its requirements.

CONCLUSION

As detailed in this document, the project meets the requirements of the CSMP. Permit applications have been submitted to all other agencies with jurisdiction.



Alex White
Environmental Permit Coordinator
Chelan County PUD
PO Box 1231 Wenatchee, WA 98807
(509) 661-8148

Exhibit A – Proposed Porta-potty Enclosure

Exhibit B – Proposed Site Plan

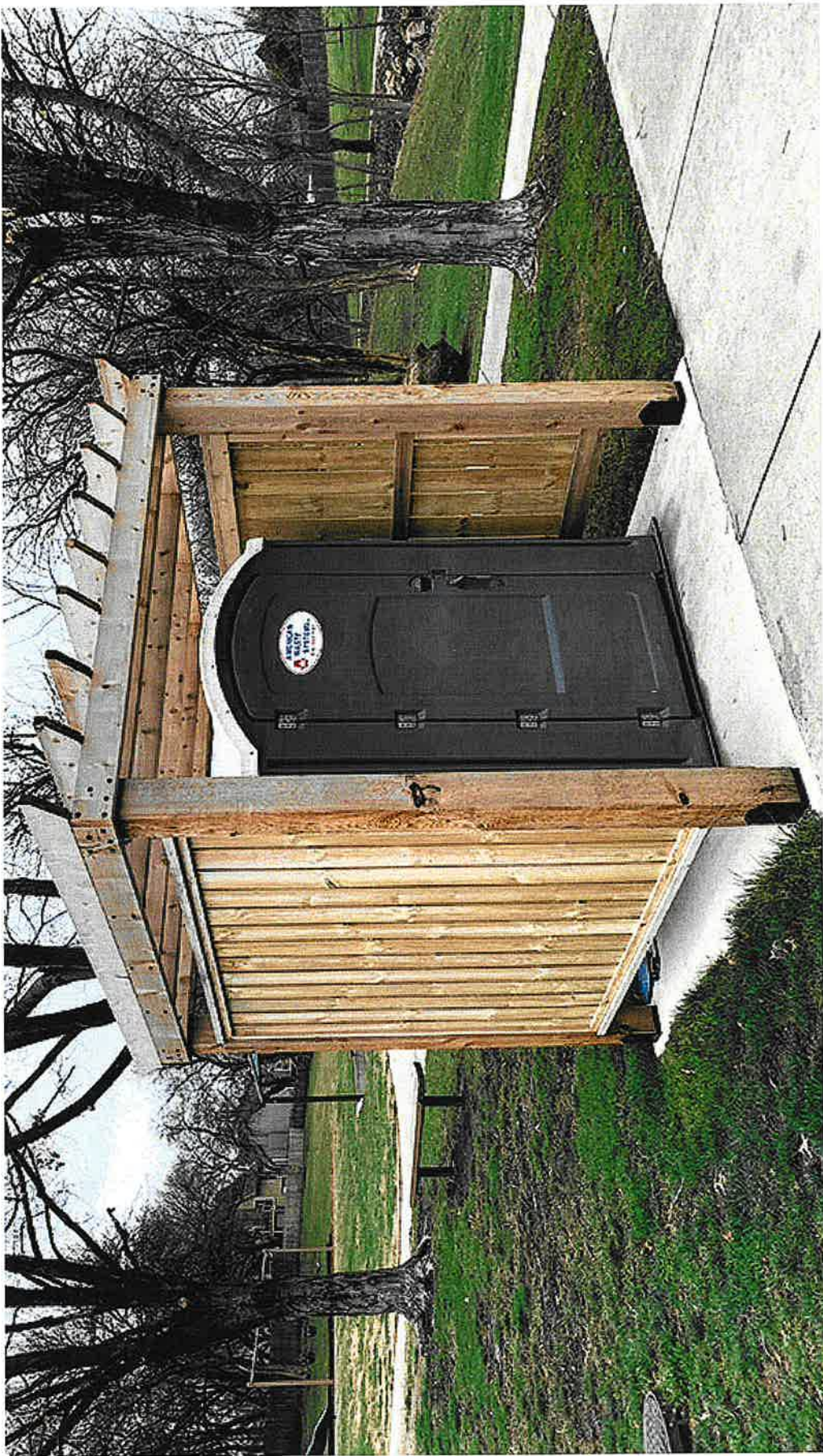

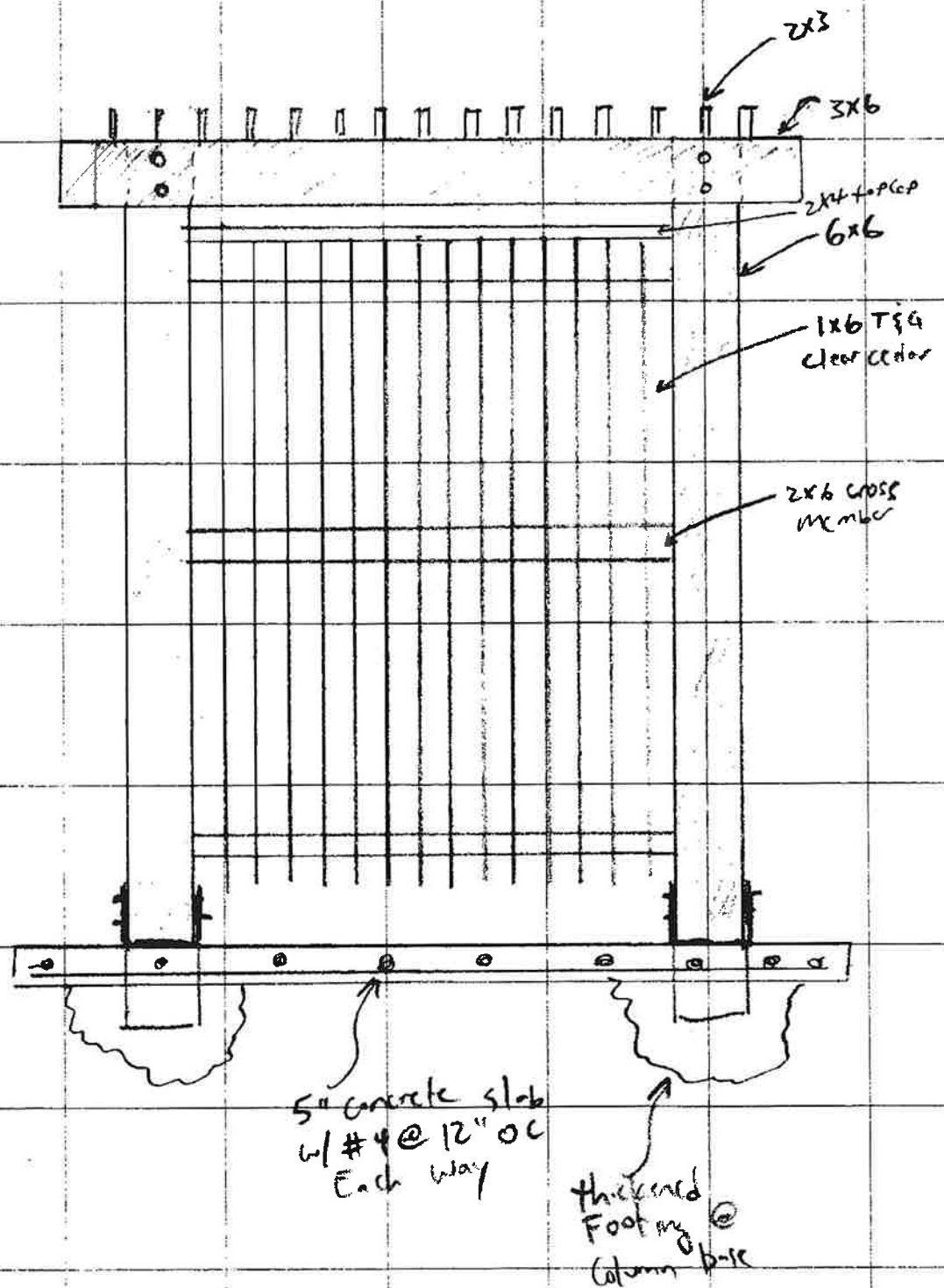

Wooden AVE ADA Porta Potty Enclosure

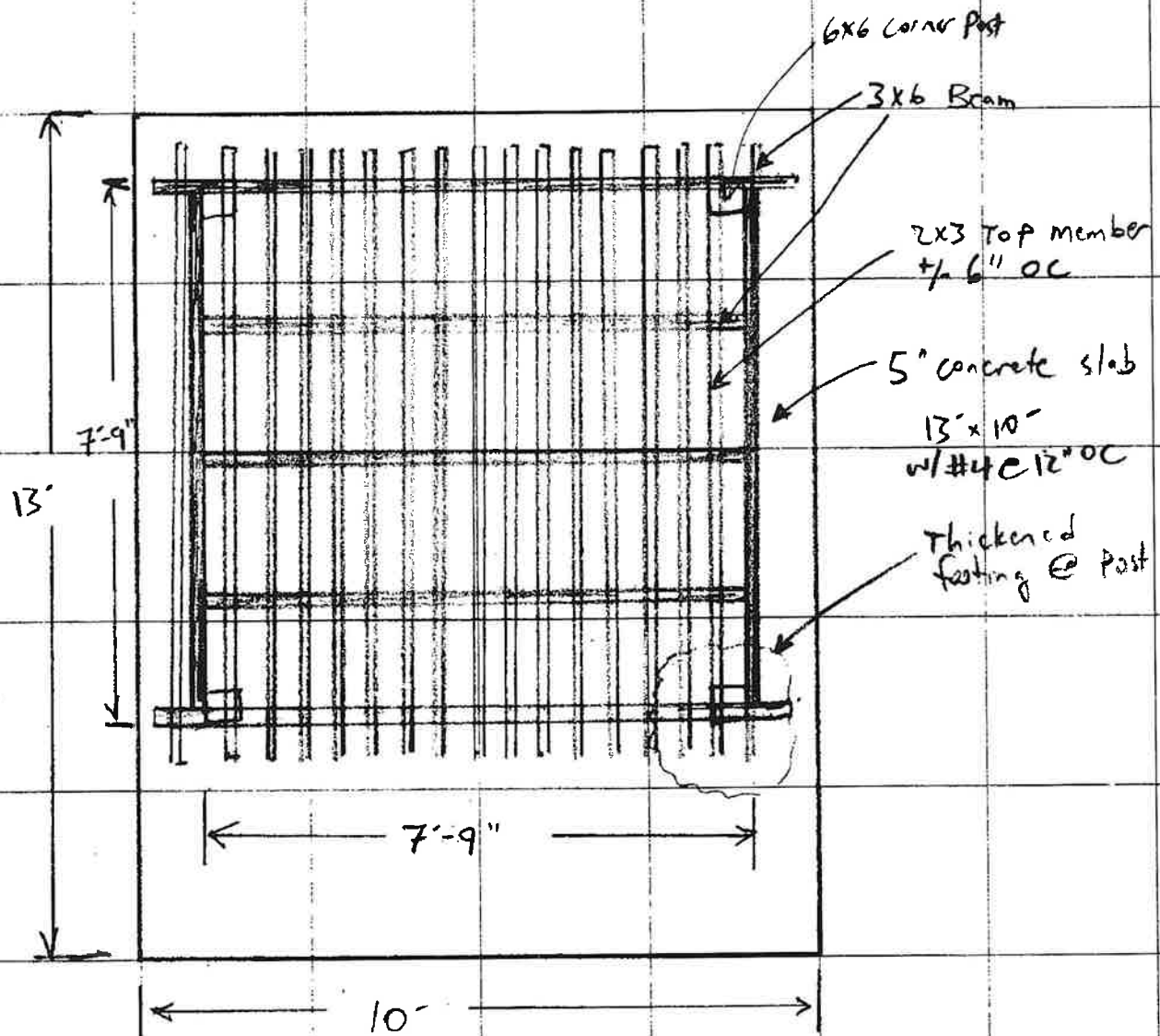



Porta Potty Enclosure

OHWM

125 ft

W Woodin Ave

W Woodin Ave

S 3rd St

W Okanogan Ave

W Okanogan Ave

W Okanogan Ave

**Porta Potty Enclosure -
Approx**



A photograph of a stone retaining wall in a park-like setting. The wall is constructed from large, grey, rectangular stone blocks. A horizontal blue line is drawn across the middle of the wall, with the text "OHWM 1098'" overlaid in blue. The wall is flanked by large, irregularly shaped rocks. In the background, there is a black metal bench, a wooden fence, and several trees with green foliage. The foreground is a light-colored, gravelly surface.

OHWM 1098'